

SCOPE: External waterproofing of below ground wall and slab structures subject to ground moisture or hydrostatic pressure.

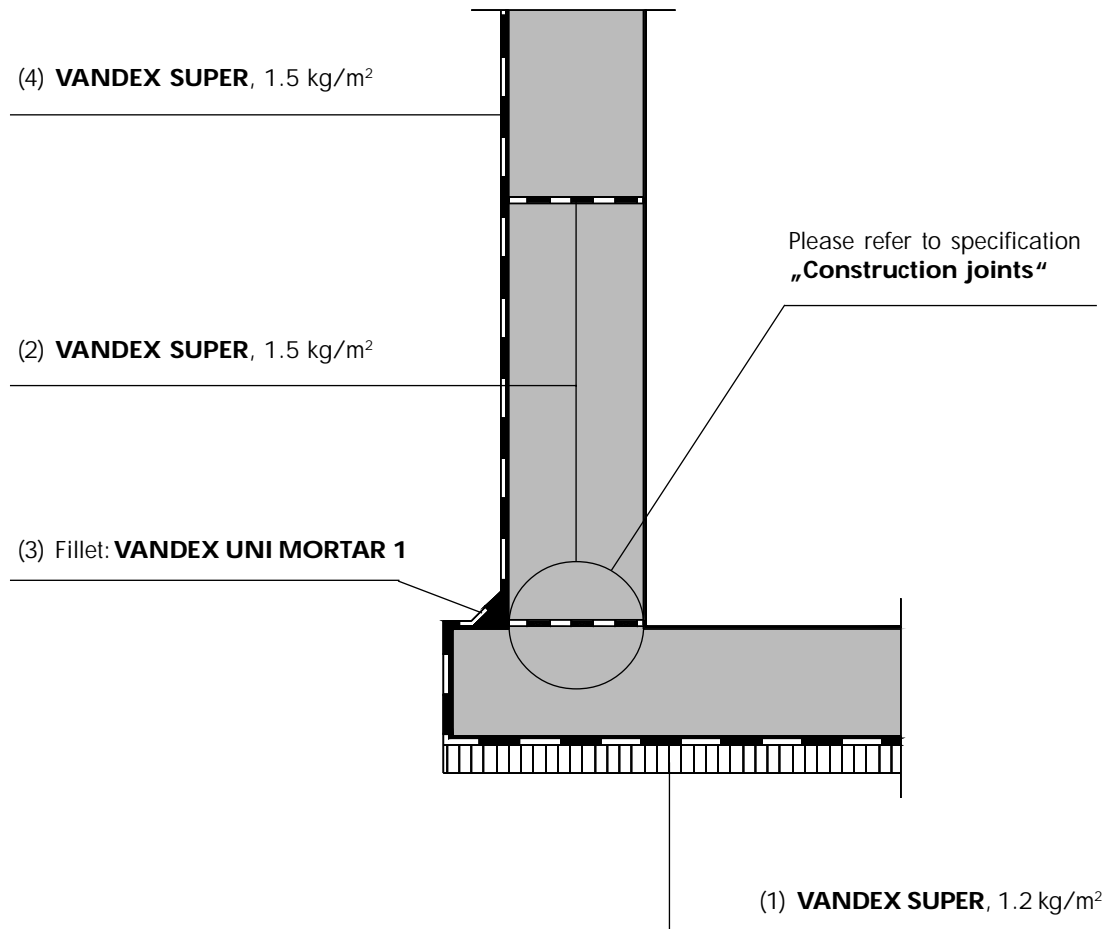

Application Instructions:

- 1.) Apply one coat of VANDEX SUPER, at the rate of 1.2 kg/m² to the prewatered blinding concrete just prior to the concrete pour.
- 2.) Apply one slurry coat of VANDEX SUPER, at the rate of 1.5 kg/m² to all construction joint surfaces. Please refer to specification „Construction joints“ for details or alternatives.
- 3.) Apply a covered fillet of VANDEX UNI MORTAR 1 at wall / floor junction.
- 4.) To the vertical surfaces and over the fillet apply two coats of VANDEX SUPER, at the rate of 0.75 kg/m² each.

The information contained herein is based on our longterm experience and the best of our knowledge. We can, however, make no guarantee since for a successful outcome, all circumstances in an individual case must be taken into consideration. Indications of quantities required are only averages which in certain cases might be greater.